

24,0m. NAVETTA

TECHNICAL SPECIFICATIONS & STANDART EQUIPMENT LIST

TABLE OF CONTENTS

	<u>PAGE</u>
1 - DIMENSIONS AND MAIN CHARACTERISTICS	3
2 - GENERAL HULL DETAILS	3
3 - INTERNAL LAYOUT	4
3.1 DOUBLE CABINS	4
3.2 MASTER CABIN	4
3.3 SALOON & DINING AREA	5
3.3.1 SEATING AREA	5
3.3.2 DINING AREA	5
3.3.3 TOILET FOR GENERAL USE	6
3.4 GALLEY	6
3.5 HELM AREA	6
3.6 CAPTAIN'S CABIN	7

	<u>PAGE</u>
3.7 CREW CABIN	7
4 - DECK LAYOUT	8
4.1 WEATHER DECK	8
4.1.1 FRONT DECK	8
4.1.2 AFT DECK	8
4.2 SUN DECK	8
5 - INSULATION	9
6 - ELECTRIC SYSTEM	9
7 - PLUMBING & WATER SYTEM	9
8 - TANK CAPACITIES	10
9 - ENGINE ROOM	10
10 - PROPELLER & SHAFT SYSTEM	11
11 - RUDDER SYSTEM	11
12 - PAINT	11
13 - MISCELLANOUS	12

1 - DIMENSIONS AND MAIN CHARACTERISTICS

Length Overall	23,99 m.	78'8''
Beam	6,0 m.	21'33''
Draft (full load)	2,0 m.	6'56''
Displacement (full load)	70 tonne	
Fuel Capacity	4000 lt.	1056,8 (usa) gals
Fresh Water Capacity	3000 lt.	792,6 (usa) gals
Gray Water Capacity	750 lt.	198,2 (usa) gals
Black Water Capacity	750 lt.	198,2 (usa) gals
Crusing Speed	10 knots	
Max Speed	13 knots	
Engines	2 x 350 hp MAN 2 x W320 ZF 3:1 Gear box	

The performance characteristics given here are due to standart equipments and calm sea and weather conditions.

2 - GENERAL HULL DETAILS

- All the materials will be supplied from the Turkish market
- The hull and deck construction material will be Marine grade steel ABS 95 Gr A.
- The superstructure will be painted marine plywood.
- In the interior construction mahogany veneered plywood will be used.
- Cabin seperation walls will be pine wood karkas and 30mm of rockwool or foam for Sound and heat isolation and planked with akaju veneered plywood.
- Cabin ceilings will be painted marine plywood.
- The Decks will be iroko planked.
- All the window will be Aluminum framed 6mm securit glass.

3 - INTERNAL LAYOUT

The living area of the yacht consist of ;

- 3 Guest cabins ; 1 master cabin at the front
2 comfortable double cabins at midship.
- 1 Saloon, dining area and a general use Toilet
- 1 Galley
- 2 Helm area ; 1 in the saloon, 1 at sun deck
- 1 Captain's cabin
- 1 Crew Cabin
- 1 Seating Group on sun deck.

3.1 DOUBLE CABINS (Each of them)

- 2 single beds; 0,85m. x 2m.
- Storage place hidden under the bed.
- 1 Wardrobe with drawers
- 1 Bookshelf
- 1 Opening type Aluminum porthole.
- 1 220 volt socket
- Light Fixtures (2 on the ceiling, 2 reading light)
- Ceiling will be white painted plywood with varnished beams at the connections.
- Cabin floor will be painted plywood
- 1 Bathroom with;
 - 1 sink
 - 1 tap
 - 1 locker
 - 1 mirror
 - 1 Shower place with shower tap
 - 1 Yacht type manuel toilet
 - 1x220 volt socket
 - Light fixtures (1 on the ceiling)
 - 1 Opening type Aluminum porthole.

3.2 MASTER CABIN

- 1 big size double bed 1,8m. x 2m.
- Storage place hidden under the beds.
- 1 Big Wardrobe with drawers
- 1 Bookshelf
- 2 Opening type Aluminum porthole.
- 1 make-up table

- 2x220 volt socket
- Light Fixtures (3 on the ceiling, 2 reading lights)
- Ceiling will be white painted plywood with varnished beams at the connections.
- Cabin floor will be painted plywood.
- One access to the bilge
- 1 Bathroom with;
 - 1 sink
 - 1 tap
 - 1 locker
 - 1 mirror
 - 1 Shower place with shower tap
 - 1 Yacht type manuel toilet
 - 1 220 volt socket
 - Light fixtures (1 on the ceiling)
 - 1 Opening type Aluminum porthole.

3.3 SALOON & DINING AREA

3.3.1 SEATING AREA

- 1 Big U-Shape Seating group for 8 Person
- 1 smaller seating group for 5 person
- 2 coffee table
- Storage place hidden under the seats.
- 2x220 volt socket
- Light Fixtures (2 on the each seating group)
- Ceiling will be white painted plywood with varnished beams at the connections.
- Floor will be painted plywood.

3.3.2 DINING AREA

- 1 Dining Table for the guests
- 6 chairs
- 1x220 volt socket
- Light Fixtures (2 on the table)
- Ceiling will be white painted plywood with varnished beams at the connections.
- Floor will be painted plywood.

3.3.3 TOILET FOR GENERAL USE

- 1 Closet (yacht type, manuel)
- 1 Stainless steel sink (29cm. diameter)
- 1 tap
- 1 220 volt socket.
- 1 Locker
- Light fixtures (1 on the ceiling)
- 1 Mirror
- Ceiling will be painted plywood.
- Floors will be plywood covered with polyester.

3.4 GALLEY

- One opening/shelf for serving food from the galley.
- 1 working bench (akaju veneered plywood top)
- 1 stainless steel sink
- 1 kitchen tap
- 1 Home type cooker and oven with LPG
- 1 Galley Aspirator (220 volt)
- 1 Refrigerator (220 volt, home type)
- 1 CO2 fire extinguishing bottle (2 kg)
- 3x220 volt socket (one for the refrigerator, 1 for the furnace 1 for spare)
- LPG system for the oven
- Light Fixtures (1 on the bar, 1 on the work bench, 1 on the ceiling)
- Ceiling will be white painted plywood with varnished beams at the connections.
- Floor will be painted plywood.

3.5 HELM AREA

- 1 Wooden Wheel, 80cm diameter
- 1 Navigation table
- 1 Map light
- 1 Thermometer&barometer set
- AC-DC Electric Switch and circuit breaker panel (Aluminum frame)
- 1 Control panel
- 2 Gas lever arm
- 1 Windlass control (up-down button)
- 1 Horn
- 2 Buttons for the engine stop
- 1 Wire arm in order to activate the windlass hydraulic pump

- 1 CO2 fire extinguishing bottle (2 kg)
- 2x220 volt socket
- 2 Access door to the deck
- Light Fixtures (2 on the control table, 1 on ceiling)
- Ceiling will be white painted plywood with varnished beams at the connections.
- Bottom will be painted plywood.

3.6 CAPTAIN'S CABIN

- 1 bed 1,2m. x 2 m.
- Storage place hidden under the bed.
- 1 Wardrobe
- 1 Bookshelf
- 1 Opening type Aluminum porthole.
- 1x220 volt socket
- Light Fixtures (1 on the ceiling, 1 reading light)
- Ceiling will be white painted plywood with varnished beams at the connections.
- Cabin floor will be painted plywood
- 1 Toilet which will be used together with the other crew members.

3.7 CREW CABIN

- 2 beds(bunk type); 0,7m. x 2 m.
- Storage place hidden under the bed.
- 1 Wardrobe
- 1 Opening type Aluminum porthole.
- 1x220 volt socket
- Light Fixtures (1 on the ceiling, 2 reading light)
- Ceiling will be white painted plywood with varnished beams at the connections.
- Cabin floor will be painted plywood.

4 - DECK LAYOUT

There will be 2 decks on the yacht; one of them is the main deck(weather deck) and the other is the sun deck.

4.1 WEATHER DECK

- The deck steel will be strengthen where needed (under the bollards and windlass)
- Guard rails (steel pipe)
- Navigation lights set (Port, starboard, bow, stern, anchor lights.)
- Deck will be iroko planked.

4.1.1 FRONT DECK

- There will be 2 bollards with adequate sizes
- Windlass will be Turkish Brand 'DATA' DZC1002 H with 12mm. Gipsy (12 volt)
- 1 Chain locker (bottom will be polyester coated plywood)
- 1 Chain locker Access (steel)
- 1 Anchor (70kg, Galvanised)
- 1 Anchor (100kg, Galvanised)
- 1 12mm and 80m. (galvanised and calibrated)
- 1 12mm and 100m. (galvanised and calibrated)

4.1.2 AFT DECK

- 1 box for the LPG bottle
- Deck lights (2 piece)
- 1 Pasarella (4m. long and made from wood)
- 1 Table for 6 person
- 6 Chairs
- 1 Suction head for dirty water (gray/black and bilge)
- 2 Fuel inlet
- 1 Fire hose outlet
- 1 Deck shower
- 1 Fresh water inlet

4.2 SUN DECK

- Second Control panel with ;
 - Gas lever arm for both engines
 - Engine displays (oil, temp, rpm.)
 - Wooden Wheel (80cm. diameter)
 - Control button for the windlass

- 1 Seating group for 6 person
- Guard rails (steel pipe)
- 1 Jet/chimney for equipment and antenna mounting
- Deck lights (2 piece)

5 - INSULATION

- There will be 30mm of Rockwool or foam for sound and heat isolation between the cabins.
- 50mm. of rockwool or Foam on the hull side of the living areas.
- 50mm. of rockwool for or Foam for the salon ceiling
- 50mm. of rockwool for the engine room ceilings and bulkhead.

6 - ELECTRIC SYSTEM

- All the electric cabling will be done by the yard. (Except the extra equipments.)
- There will be both 12 volt and 220 volt electric systems on the boat.
- 7 kW capacity Generator, Onan or equivalent.(as a 220 volt source)
- 7 Piece of 200Ah battery (1 for engine start)
- 1 Piece of 90 Ah battery (for generator start)
- 1 Battery charger (100 Ah, 12 volt)
- Invertor (2000 Watt, 12 volt)
- 1 Alternator (engine mounted battery charging device)
- 1 Isolation transformer 32A
- 1 Electric main switch
- 1 Shore plug (with 20m. shore cable)
- AC-DC Electric Switch and circuit breaker panel (it is mentioned before, in the helm area section) (with all the fuses, ampermeter and voltmeter and a selector switch)
- AC-DC Electric Distribution panels (in the engine room)
- Zinc Anodes (2 kg, 8 piece for the hull, 2 piece for the shaft)

7 - PLUMBING & WATER SYTEM

- All the Piping in the engine room will be galvanised steel (Except the fuel hoses)
- All the other piping will be plastic.
- All valves will be ball valf
- There will be hot and cold fresh water system in the boat.
- 1 Fresh Water pump (12 volt, adequate size)
- 1 Engine driven pump (12 volt, multi-purpose for fire/deck washing system, bilge discharge, and gray/black water discharge)

- 1 Macerator pump (12 volt and for black and gray water discharge)
- 3 Separate submersible bilge pumps for each cabins(with their automatic switches)
- 1 Water heater (75 lt. capacity, 220 volt)

8 - TANK CAPACITIES

tank capacities will be as follows;

➤ Fuel Capacity	4000 lt.	1056,8 (usa) gals
➤ Fresh Water Capacity	3000 lt.	792,6 (usa) gals
➤ Gray Water Capacity	750 lt.	198,2 (usa) gals
➤ Black Water Capacity	750 lt.	198,2 (usa) gals

9 - ENGINE ROOM

- 2 x 350 hp MAN, 2866 LXE40
- 2 x W320 ZF Gear box.
- Steel engine foundation for the engines
- 4 Engine mounts for each engine
- Engine Exhaust systems will be as follows
 - 1 Water lock
 - 1 Expansion joint
 - Adequate size exhaust hose, steel pipes and stainless steel clamps
 - Stainless steel elbow at the hull for discharge.
- Generator Exhaust system will be as follows
 - 1 Water lock (will be made by the yard or to be bought)
 - Adequate size exhaust hose and stainless steel clamps.
 - Stainless steel elbow through the hull for discharge.
- Fuel level display. A hose with a push-up button or an equivalent system.
- 3 Separ type fuel Filter/separator 2 for the engine and the other for the generator.
- 3 Sea Water Filter 1 for the engine and the other for the generator.
- Engine room floor will be checkered plate.
- Aluminum plate cover to the bulkheads
- 2 Access for the engine room.(One for daily use, one for emergency case)
- 1 Natural air ventilation, with shut-off valf.
- 2 220 volt socket.
- 4 Engine room lights

10 - PROPELLER & SHAFT SYSTEM

- 2 Propeller
- 2 Propeller end stud, bronze
- 2 Stainless steel shaft (SS 316 or 316 L)
- 2 Steel Stern tube (Water lubricated Rubber bearing fitted inside)
- 2 Deep-sea seal, Turkish brand 'ERMAKSAN' or equivalent.
- 2 Steel coupling for shaft-engine connection.

11 -RUDDER SYSTEM

- Rudder mechanism will be Turkish brand 'DATA' DS150 type hydraulic system (with manual clutch and separable hydraulic tank, 12 volt) or equivalent.
- 2 Rudder (steel plate)
- 2 Stainless steel shaft (SS 316 or 316 L)
- 2 Steel shaft tube
- 2 Bronze stuffing box and gland
- 2 Rudder holding system and steel foundation for the rudder
- 1 Emergency tiller (steel)

12 - PAINT

- All steel construction will be sand blasted and painted with Jotun Epoxy Holding Primer.
- All the paint & epoxy system will be Turkish brand 'Sar Kimya' or 'Teknomarin'
- All the interior furniture will be varnished.
- All the cabin ceilings will be white painted.
- The superstructure outside walls will be painted.
- The decks will be painted with non-slip paint.
- The underwater body of the hull will be painted antifouling undercoat and paint.

13- MISCELLANEOUS

If it is decided to take any Classification or CE marking the extra cost will be added to the total price.

- The items below are included in the price and/or they are the due of the yard.
- Cargo and Transports (except the extra equipment and materials)
- Transportation insurances (except the extra equipment and materials)
- Custom formalities
- Project of the boat
- Yacht insurance
- Launching of the boat

Documento Redatto da
www.caiccomania.com

MOTOR YACHT 24.0
CLASSIC LINE

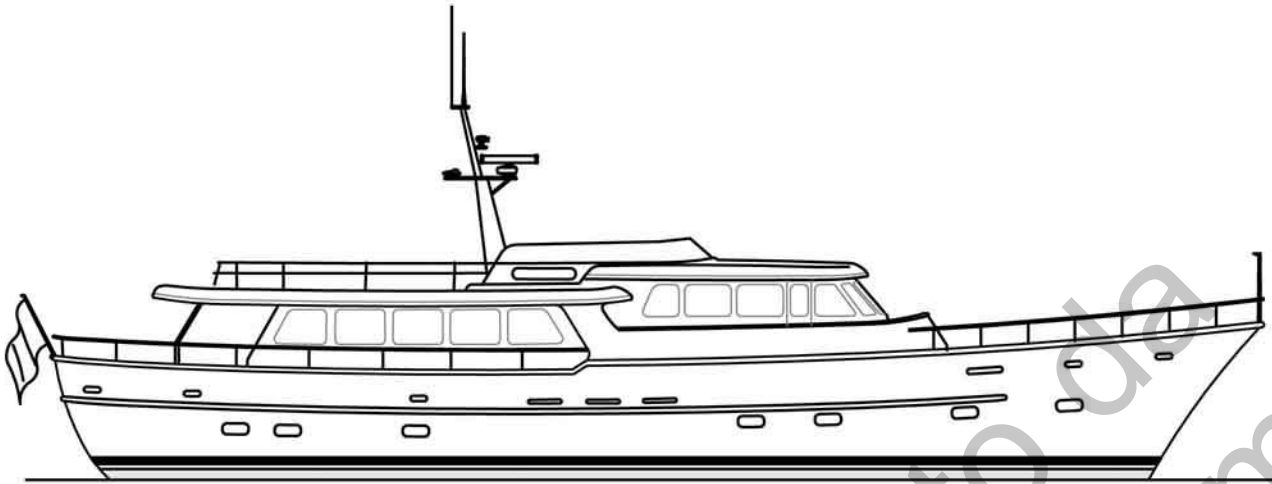

SIDE VIEW

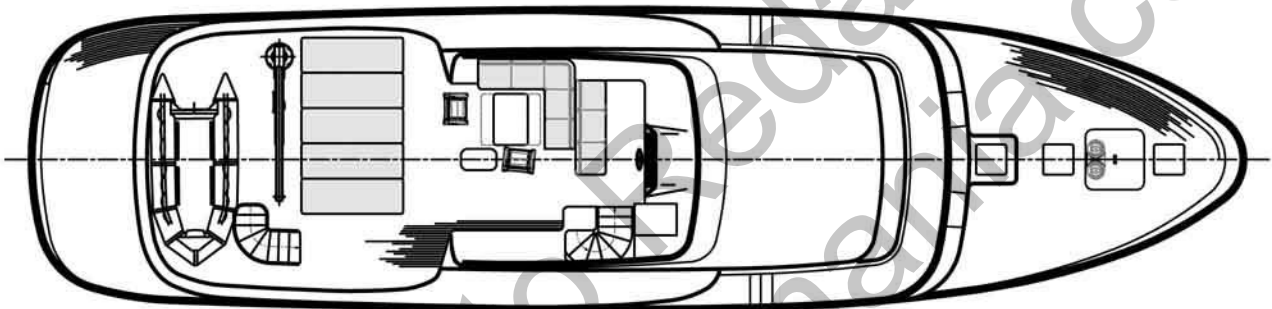

PLAN VIEW
SKY LOUNGE

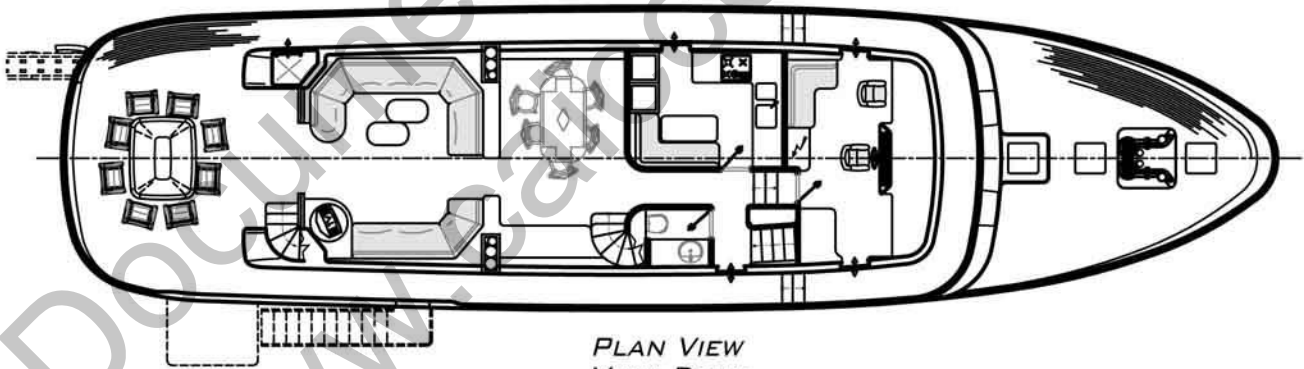

PLAN VIEW
MAIN DECK

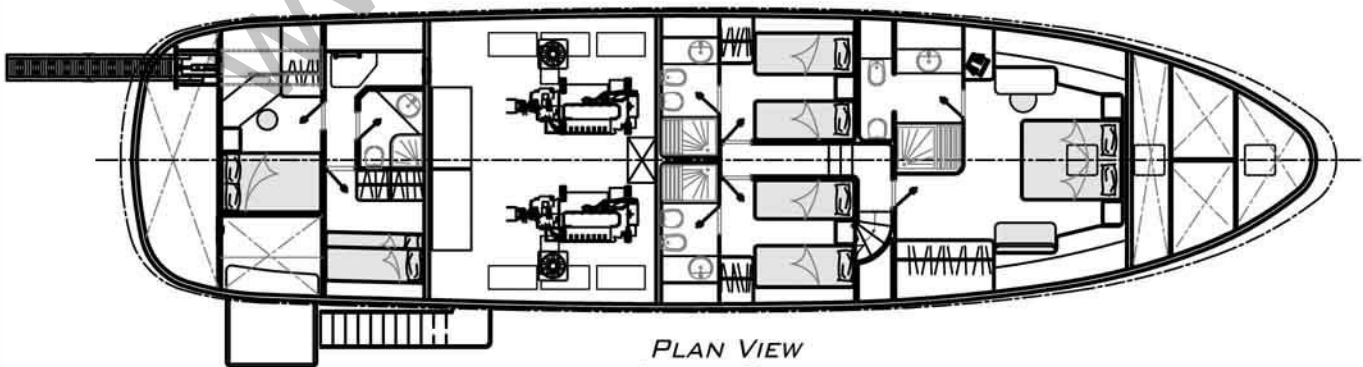

PLAN VIEW
LOWER DECK

