

CLASSICAL LINE NAVETTA

TECHNICAL SPECIFICATIONS & STANDART EQUIPMENT LIST

TABLE OF CONTENTS

	<u>PAGE</u>
1 - DIMENSIONS AND MAIN CHARACTERISTICS	3
2 - GENERAL HULL DETAILS	3
3 - INTERNAL LAYOUT	4
3.1 DOUBLE CABINS	4
3.2 MASTER CABIN	4
3.3 SALOON & DINING AREA	5
3.3.1 SEATING AREA	5
3.3.2 TOILET FOR GENERAL USE	6
3.4 GALLEY	6
3.5 HELM AREA	6
3.7 CREW CABIN	6

	<u>PAGE</u>
4 - DECK LAYOUT	7
4.1 WEATHER DECK	7
4.2 FLYBRIDGE	7
5 - INSULATION	8
6 - ELECTRIC SYSTEM	8
7 - PLUMBING & WATER SYTEM	8
8 - TANK CAPACITIES	9
9 - ENGINE ROOM	9
10 - PROPELLER & SHAFT SYSTEM	10
11 - RUDDER SYSTEM	10
12 - PAINT	10
13 - NAVIGATION EQUIPMENTS / ELECTRONICS	10
14 - MISCELLANOUS	11

1 - DIMENSIONS AND MAIN CHARACTERISTICS

Length Overall	19,4 m.
Beam	5,5 m.
Draft (full load)	1,8 m.
Displacement (full load)*	70 tonne*
Fuel Capacity	6500 lt.*
Fresh Water Capacity	2500 lt.*
Gray Water Capacity	750 lt.*
Black Water Capacity	750 lt.*
Crusing Speed	15 knots*
Max Speed	25 knots*
Engines	2 x 1000 HP MAN*

The performance characteristics given here are due to standart equipments and calm sea and weather conditions.

2 - GENERAL HULL DETAILS

- All the materials will be supplied from the Turkish market
- The hull and deck construction material will be Marine grade steel ABS 95 Gr A.
- The superstructure will be painted marine plywood.
- In the interior construction mahogany veneered plywood will be used.
- Cabin seperation walls will be pine wood karkas and 30mm of rockwool or foam for Sound and heat isolation and planked with akaju veneered plywood.
- Cabin ceilings will be light weight material.
- The Decks will be iroko planked.
- All the window will be Aluminum framed 6mm securit glass.

3 - INTERNAL LAYOUT (Will be changed according to plan)

The living area of the yacht consist of ;

- 3 Guest cabins ; 1 master cabin
 - 2 comfortable double cabins
- 1 Saloon, dining area and a general use Toilet
- 1 Galley
- 2 Helm area ; 1 in the saloon, 1 at sun deck
- 1 Crew Cabin
- 1 Seating Group on sun deck.

3.1 DOUBLE CABINS (Each of them)

- 2 single beds; 0,85m. x 2m.
- Storage place hidden under the bed.
- 1 Wardrobe with drawers
- 1 Opening type Aluminum porthole.
- 1 220 volt socket
- Light Fixtures (2 on the ceiling, 2 reading light)
- Cabin ceilings will be light weight material.
- Cabin floor will be painted plywood and will be carpet furnished.
- 1 Bathroom with;
 - 1 sink
 - 1 tap
 - 1 locker
 - 1 mirror
 - 1 Shower place with shower tap
 - 1 Yacht type normal size electrical toilet
 - 1x220 volt socket
 - Light fixtures (1 on the ceiling)
 - 1 Opening type Aluminum porthole.

3.2 MASTER CABIN

- 1 big size double bed 1,8m. x 2m.
- Storage place hidden under the beds.
- 1 Big Wardrobe with drawers
- 1 Bookshelf
- Sofa
- 3 Opening type Aluminum porthole.
- 1 make-up table
- 2x220 volt socket

- Light Fixtures (3 on the ceiling, 2 reading lights)
- Cabin ceilings will be light weight material.
- Cabin floor will be painted plywood and will be carpet furnished.
- One access to the bilge
- 1 Bathroom with;
 - 1 sink
 - 1 tap
 - 1 locker
 - 1 mirror
 - 1 Shower place with shower tap
 - 1 Yacht type normal size electrical toilet
 - 1 220 volt socket
 - Light fixtures (1 on the ceiling)
 - 1 Opening type Aluminum porthole.

3.3 SALOON & DINING AREA

3.3.1 SEATING AREA

- 1 Big U-Shape Seating group for 8 Person
- 1 Smaller seating group for 5 person
- 1 Table
- Storage place hidden under the seats.
- 2x220 volt socket
- Light Fixtures (2 on the seating group, 3 on the ceiling)
- Cabin ceilings will be light weight material.
- Floor will be painted plywood and will be carpet furnished.

3.3.2 TOILET FOR GENERAL USE

- 1 Closet (yacht type, normal size electrical toilet)
- 1 Stainless steel sink (29cm. diameter)
- 1 tap
- 1 220 volt socket.
- 1 Locker
- Light fixtures (1 on the ceiling)
- 1 Mirror
- Cabin ceilings will be light weight material.
- Floor will be plywood covered with polyester.

3.4 GALLEY

- One opening/shelf for serving food from the galley.
- 1 working bench (stainless steel)
- 1 stainless steel sink.
- 1 kitchen tap
- 1 Home type electrical cooker and oven
- 1 Galley Aspirator (220 volt)
- 1 Refrigerator (220 volt, home type)
- 1 Microwave oven
- 1 CO2 fire extinguishing bottle (2 kg)
- 3x220 volt socket (one for the refrigerator, 1 for the furnace 1 for spare)
- Light Fixtures (1 on the bar, 1 on the work bench, 1 on the ceiling)
- Ceilings will be lightweight material.
- Floor will be painted plywood and will be carpet furnished.

3.5 HELM AREA

- 1 Stainless steel Wheel, 80cm diameter
- 1 Navigation table
- 1 Map light
- 1 Thermometer&barometer set
- AC-DC Electric Switch and circuit breaker panel (Aluminum frame)
- 1 Control panel
- 2 Gas lever arm
- 1 Windlass control (up-down button)
- 1 Horn
- 2 Buttons for the engine stop
- 1 Wire arm in order to activate the windlass hydraulic pump
- 1 CO2 fire extinguishing bottle (2 kg)
- 2x220 volt socket
- 2 Access door to the deck
- Light Fixtures (2 on the control table, 1 on ceiling)
- Ceilings will be lightweight material.
- Bottom will be painted plywood.

3.7 CREW CABIN

- 2 beds(bunk type); 0,7m. x 2 m.
- Storage place hidden under the bed.
- 1 Wardrobe

- 1 Opening type Aluminum porthole.
- 1x220 volt socket
- Light Fixtures (1 on the ceiling, 2 reading light)
- Ceilings will be lightweight material.
- Cabin floor will be painted plywood and will be carpet furnished.

4 - DECK LAYOUT

There will be 2 decks on the yacht; one of them is the main deck(weather deck) and the other is the fly bridge

4.1 WEATHER DECK

- The deck steel will be strengthen where needed (under the bollards and windlass)
- Guard rails (steel pipe)
- Navigation lights set (Port, starboard, bow, stern, anchor lights.)
- Deck will be iroko planked.
- There will be 4 bollards with adequate sizes; 2 at the front, 2 at the aft
- Windlass will be Turkish Brand 'DATA' DZC1002 H with 12mm. Gipsy (12 volt)
- 1 Chain locker (bottom will be polyester coated plywood)
- 1 Chain locker Access (steel)
- 1 Anchor (100kg, Galvanised)
- 1 Anchor (100kg, Galvanised)
- 1 12mm and 100m. (galvanised and calibrated)
- 1 12mm and 100m. (galvanised and calibrated)
- 1 Pasarella (4m. long and made from wood)
- 1 Suction head for dirty water (gray/black and bilge)
- 2 Fuel inlet
- 1 Fire hose outlet
- 1 Deck shower
- 1 Fresh water inlet
- Deck lights (2 piece)

4.2 FLY BRIDGE

- Second Control panel with ;
 - Gas lever arm for both engines
 - Engine displays (oil, temp, rpm.)
 - Stainless Steel Wheel (80cm. diameter)
 - Control button for the windlass

- Control button for bow-thruster
- Control button for stabilisers
- 1 Seating group for 8 person
- Guard rails (steel pipe)
- 1 Jet/chimney for equipment and antenna mounting
- Deck lights (2 piece)

5 - INSULATION

- There will be 30mm of Rockwool for sound and heat isolation between the cabins.
- 50mm. of rockwool on the hull side of the living areas.
- 50mm. of rockwool for the salon ceiling
- 50mm. of rockwool for the engine room ceilings and bulkhead.

6 - ELECTRIC SYSTEM

- All the electric cabling will be done by the yard. (Except the extra equipments.)
- There will be both 12 or 24 volt and 220 volt electric systems on the boat.
- 2 x16 kW capacity Generator, Onan or equivalent.(as a 220 volt source)
- 7 Piece of 200Ah battery (1 for engine start)
- 2 Piece of 90 Ah battery (for generator start)
- 1 Battery charger (200 Ah, 12 volt)
- Invertor (2000 Watt, 12 volt)
- 1 Alternator (engine mounted battery charging device)
- 1 Isolation transformer 32A
- 1 Electric main switch
- 1 Shore plug (with 50m. shore cable)
- AC-DC Electric Switch and circuit breaker panel (it is mentioned before, in the helm area section) (with all the fuses, ampermeter and voltmeter and a selector switch)
- AC-DC Electric Distribution panels (in the engine room)
- Zinc Anodes (Enough number for the boat size, 2 piece for the shaft)

7 - PLUMBING & WATER SYTEM

- All the Piping in the engine room will be galvanised steel (Except the fuel hoses)

- All the other piping will be thermoplastic.
- All valves will be ball valf
- There will be hot and cold fresh water system in the boat.
- 1 Fresh Water pump (12 volt, adequate size)
- 1 Engine driven pump (12 volt, multi-purpose for fire/deck washing system, bilge discharge, and gray/black water discharge)
- 2 Macerator pump (220 volt and for black and gray water discharge)
- 3 Seperate submergible bilge pumps for each cabins(with their automatic switches)
- 1 Water heater (75 lt. capacity, 220 volt)

8 - TANK CAPACITIES

tank capacities will be as follows;

- | | |
|-----------------------------|-----------|
| ➤ Fuel Capacity | 6500 lt.* |
| + daily tank for clean fuel | |
| ➤ Fresh Water Capacity | 2500 lt.* |
| ➤ Gray Water Capacity | 750 lt.* |
| ➤ Black Water Capacity | 750 lt.* |

9 - ENGINE ROOM

- 2 x 1280 HP MAN
- Steel engine foundation for the engines
- 4 Engine mounts for each engine(rubber vibration control)
- Engine Exhaust systems will be as follows
 - 2 Water lock
 - 2 Expansion joint
 - Adequate size exhaust hose, steel pipes and stainless steel clamps
 - Stainless steel elbow at the hull for discharge.
- Generator Exhaust systems will be as follows
 - 2 Water lock (will be made by the yard or to be bought)
 - Adequate size exhaust hose and stainless steel clamps.
 - Stainless steel elbow through the hull for discharge.
- Fuel level display. A hose with a push-up button or an equivalent system.
- 4 Separ type fuel Filter/separator 2 for the engine and 2 for the generator.
- 4 Sea Water Filter 2 for the engines and 2 for the generators.
- Engine room floor will be checkered plate.
- Aluminum plate cover to the bulkheads
- 2 Access for the engine room.(One for daily use, one for emergency case)
- 2 electrical blowers, with shut-off valf.

- 2 220 volt socket.
- 4 Engine room lights
- 1 work bench for utensils.

10 - PROPELLER & SHAFT SYSTEM

- 2 Propeller
- 2 Propeller end stud, bronze
- 2 Stainless steel shaft
- 2 Steel Stern tube (Water lubricated Rubber bearing fitted inside)
- 2 Deep-sea seal, Turkish brand 'ERMAKSAN' or equivalent.
- 2 Flexible coupling for shaft-engine connection.

11 - RUDDER SYSTEM

- Rudder mechanism will be Turkish brand 'DATA' Electro hydraulic type hydraulic system
- 2 Rudder (steel plate)
- 2 Stainless steel shaft
- 2 Steel shaft tube
- 2 Bronze stuffing box and gland
- 2 Rudder holding system and steel foundation for the rudder
- 1 Emergency tiller (steel)

12 - PAINT

- All steel construction will be sand blasted and painted with Jotun Epoxy Holding Primer.
- All the paint & epoxy system will be Turkish brand 'Sar Kimya' or 'Teknomarin'
- All the interior furniture will be varnished.
- The superstructure outside walls will be painted.
- The decks will be painted with non-slip paint.
- The underwater body of the hull will be painted antifouling undercoat and paint.

13 - NAVIGATION EQUIPMENTS / ELECTRONICS

- Auto pilot
- Stabiliser
- 48m. Radar
- Bow thruster
- GPS + Chart plotter
- Speed / Depth Indicator.

14- MISCELLANEOUS

If it is decided to take any Classification or CE marking the extra cost will be added to the total price.

- The items below are included in the price and/or they are the due of the yard.
- Cargo and Transports (except the extra equipment and materials)
- Transportation insurances (except the extra equipment and materials)
- Custom formalities
- Project of the boat
- Yacht insurance
- Launching of the boat

Documento Redatto da
www.caiccomania.com

MOTOR YACHT 19.8
CLASSIC LINE

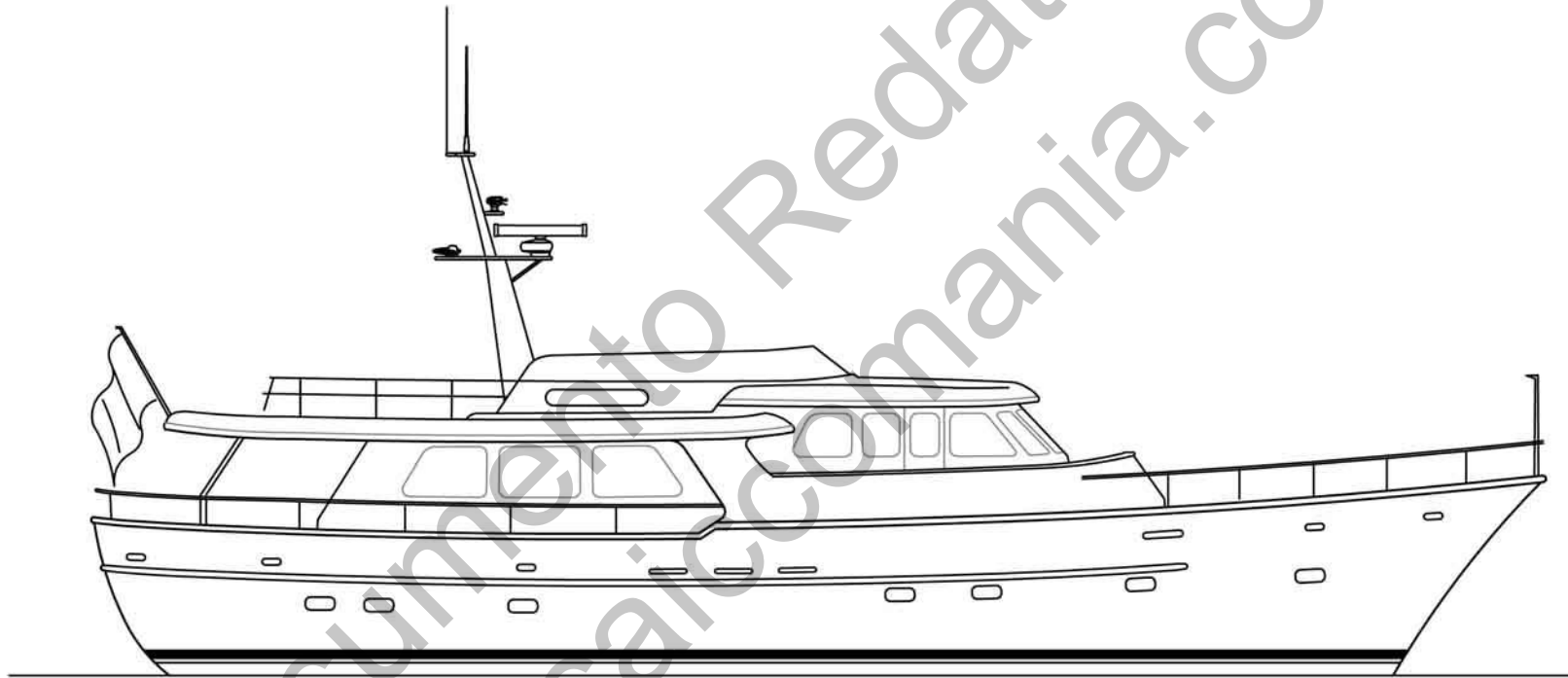

SIDE VIEW



MOTOR YACHT 18.5
CLASSIC LINE

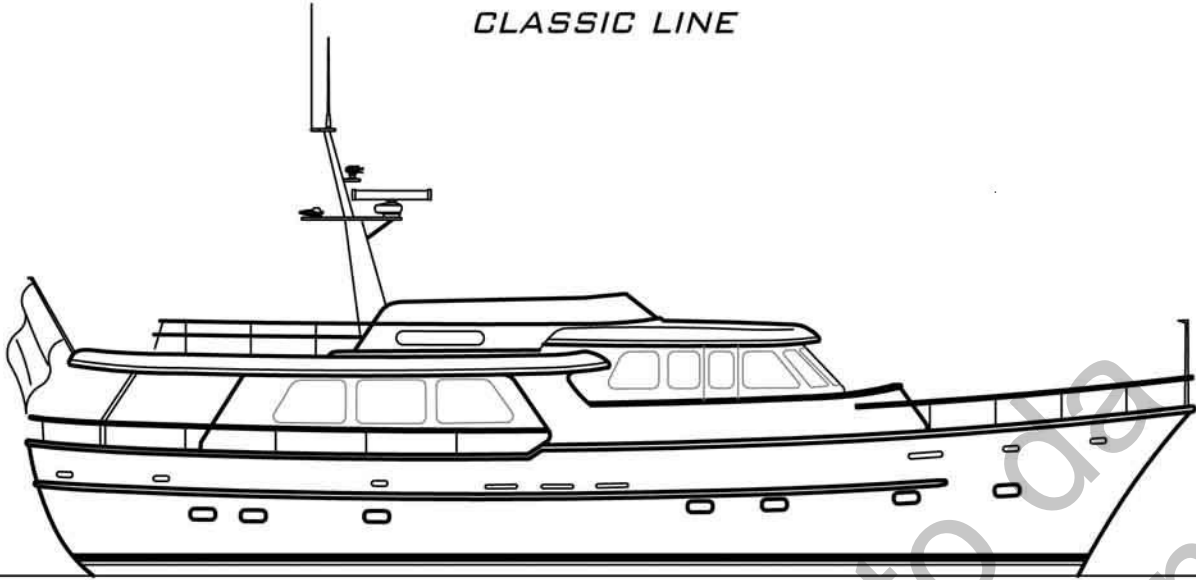

SIDE VIEW

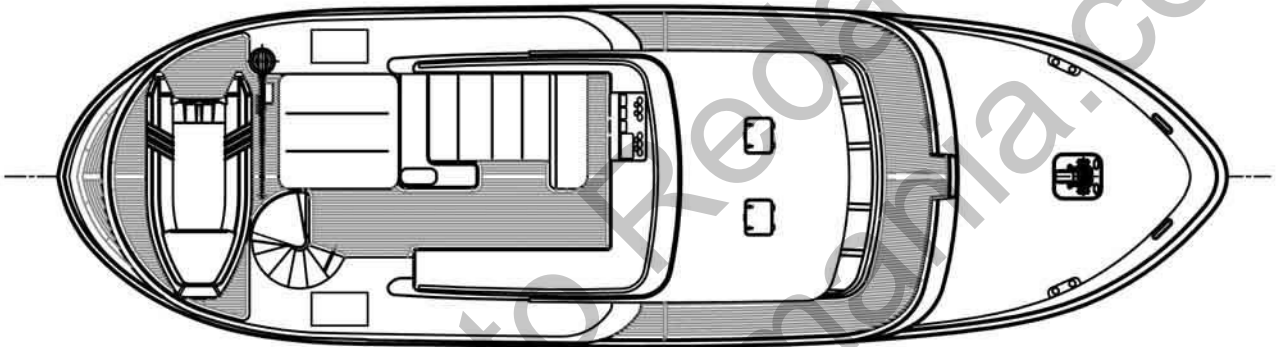

PLAN VIEW
SKY LOUNGE

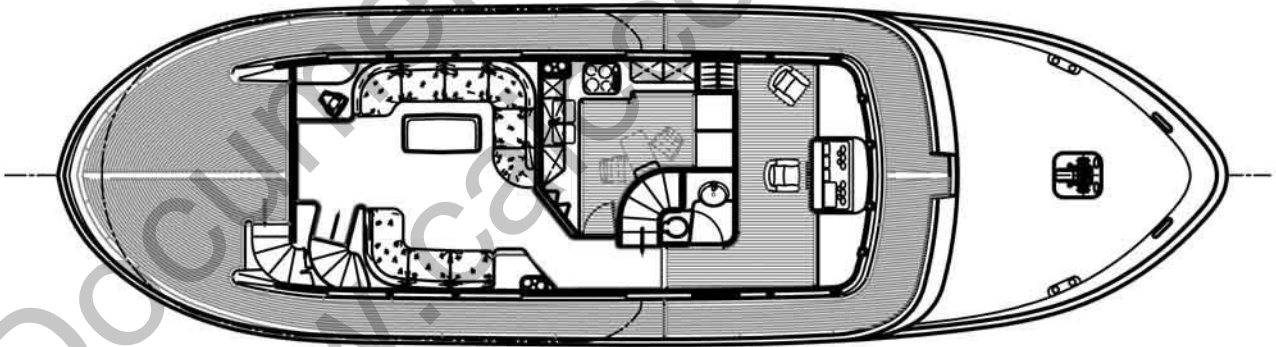

PLAN VIEW
MAIN DECK

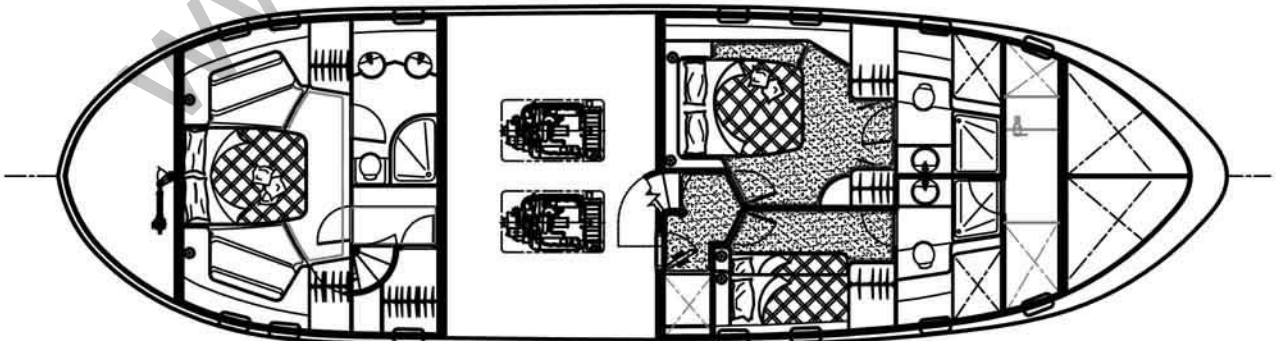

PLAN VIEW
LOWER DECK

